

Tusk Quiet Glide Skid Plate Kawasaki KRX4 1000









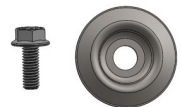

Part number# 1276440042

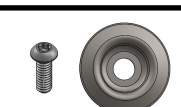

INSTALLATION INSTRUCTIONS AND INFORMATION

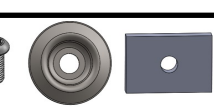
Thank you for purchasing a Tusk Quiet-Glide Skid Plate. Become familiar with the skid plate hardware chart below and refer back to this page during installation of the skid plate. Please read through the instructions from start to finish before you begin the install. Get familiar with this product and installation steps, if you are not comfortable performing this install, it is recommended that you take the skid plate and your machine to a qualified mechanic for install.

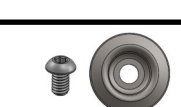
Tusk Quiet Glide Skid Plate Hardware

<p>A</p>  <p>(26) Tusk Cup Washer (26) M6 x 16mm Hex Flange Bolt</p>	<p>Vehicle Fitment Kawasaki KRX4 1000 - 2023</p>
<p>B</p>  <p>(8) Tusk Cup Washer (8) M6 x 25mm Hex Flange Bolt (8) 3/8" x 1" x 1" UHMW Spacer</p>	 <p>9/32" Drill Bit (1)</p>  <p>7/32" Drill Bit (1)</p>
<p>C</p>  <p>(2) Tusk Cup Washer (2) M6 x 25mm Hex Flange Bolt (2) 1/2" x 1" x 1" UHMW Spacer</p>	
<p>D</p>  <p>(4) Tusk Cup Washer (4) 5/16" x 3/4" Self Threading Screw Drill 9/32 Hole Required</p>	<p>G</p>  <p>(12) Tusk Aluminum Cup Washer (12) M6 x 25mm Button Head Bolt</p>
<p>E</p>  <p>(3) Tusk Cup Washer (3) 5/16" x 3/4" Self Threading Screw (3) 1" x 1-1/2" Nut Plate</p>	<p>H</p>  <p>(2) Tusk Aluminum Cup Washer (2) M6 x 20mm Button Head Bolt (2) M6 Flange nut Drill 9/32" Hole Required</p>
<p>F</p>  <p>(2) Tusk Cup Washer (2) 5/16" x 1/2" Self Threading Screw Drill 9/32" Hole Required</p>	<p>J</p>  <p>(10) Tusk Aluminum Cup Washer (10) 1/4" x 1/2" Self Tapping Screw Drill 7/32" Hole Required</p>

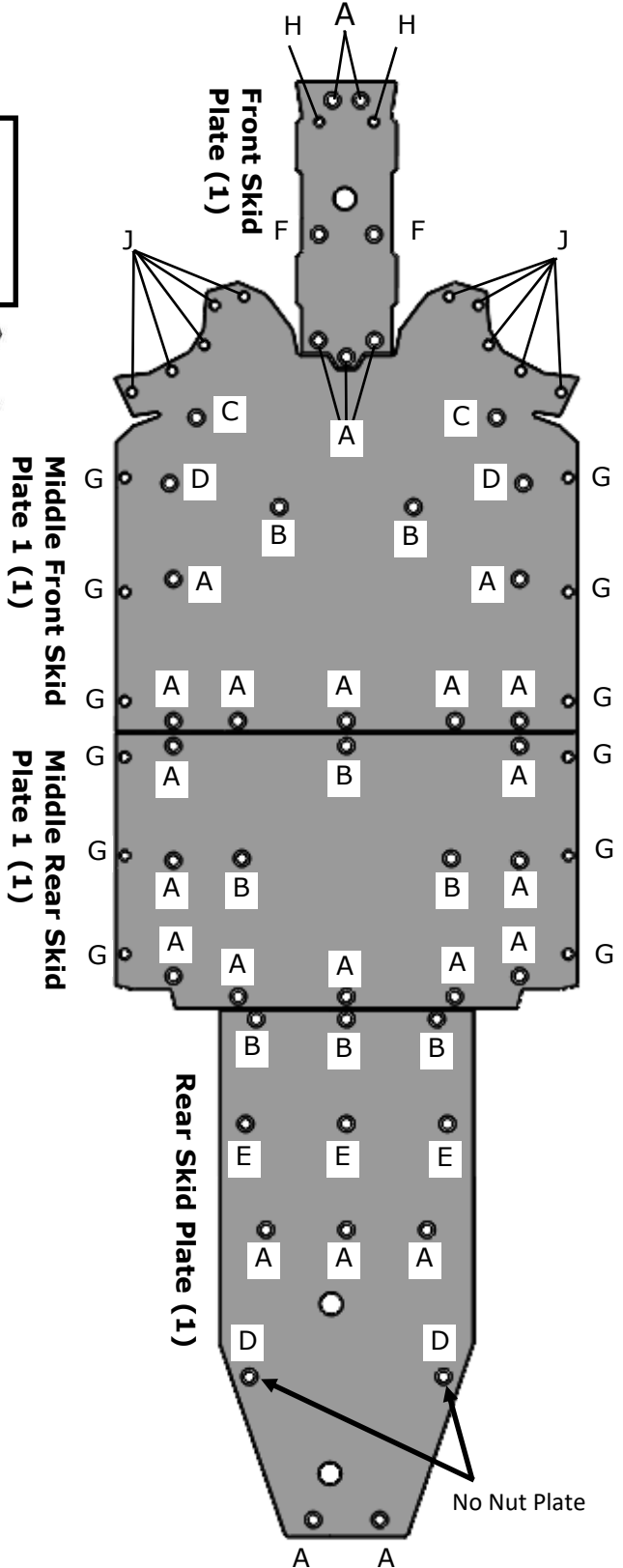

Tusk Quiet Glide Skid Plate Kawasaki KRX4 1000

Installation Rear Skid Plate Section Instructions:

1. Raising your vehicle off of the ground is the easiest way to install your new Tusk Skid Plate. Ramps are the most efficient way to do this. It is still possible to perform this installation without raising the machine off the ground but may prove to be very difficult. Remove the existing 2 rear skid plates, you will not be re-using the OEM hardware for the installation of the Tusk Quiet Glide Skid Plate.
2. Bend Skid plate at the machined groove location. The skid plate is pre bent, but can relax after manufacturing. Adding bend can assist with the installation.
3. Locate the rear section of the Tusk Quiet Glide Skid Plate as shown in the image below. You will be installing this section first, locate the following corresponding hardware for this skid plate section (B), (E), (A), and (D), listed below.
4. Next, place rear skid section on the machine, install combination hardware (A) first. This hardware will thread into existing OEM frame welded nuts, leave the bolts loose for now. Install combination hardware (E). Hardware (E) will fasten using a 1" x 1-1/2" threaded nut plate that will rest on the frame of the machine sandwiching the frame and skid plate together. Next, locate hardware combination (B), this hardware will also thread into existing OEM frame welded nuts. Place the UHMW spacer between the frame and the skid plate as shown below. Next, Install Hardware (D) using provided 9/32" drill bit carefully drill through the machine and install combination hardware (D). Locations already have pilot holes from the factory. Tighten all hardware at this point, you might have to loosen hardware at a later step for adjustment.

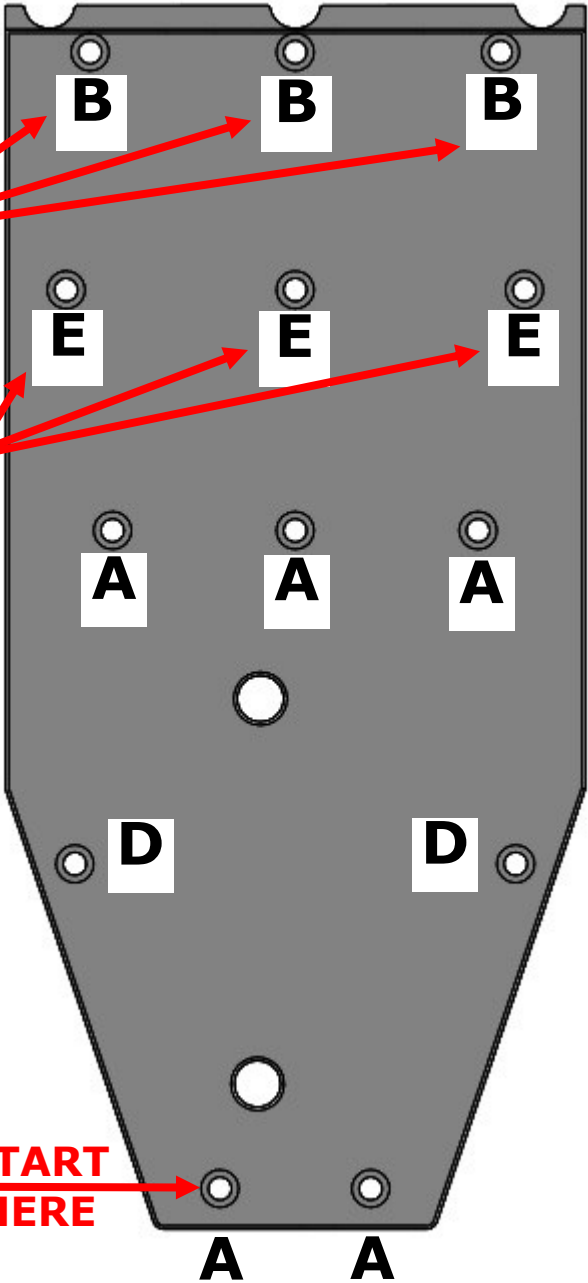
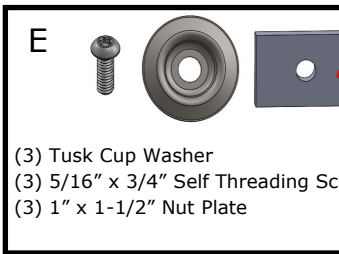
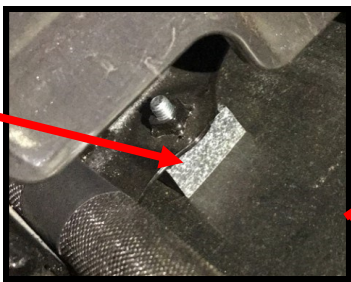
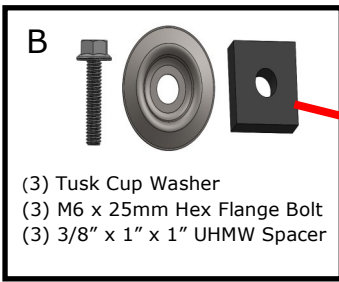

Tusk Rear Skid Plate Section

Tusk Quiet Glide Skid Plate Kawasaki KRX4 1000

Installation Middle Rear Skid Plate Section:

5. Remove the existing 3 OEM bolts and 3 OEM washers from the front of the factory skid plate, see image. *It is optional to remove the OEM Middle Rear skid plate.*
6. Locate the supplied Tusk Middle Rear Skid Plate and supplied corresponding hardware shown below. Begin installing the middle section of the skid plate using combination hardware (A) first. These bolts will thread into existing OEM frame welded nuts, loosely thread the bolts into outlined locations shown below. Locate and install combination hardware (B), place the provided UHMW spacers between the OEM welded frame nut and skid plate, thread the bolts and leave loose for now.
7. Next, locate and install combination hardware (G). The bolts will thread into existing OEM threaded locations securing the sides of the skid plate, leave these loose for now. *If bolts are difficult to install Bend Skid plate at the machined groove location. The skid plate is pre bent, but can relax after manufacturing. Adding bend can assist with the installation.*
8. When installing all hardware combinations, follow the outlined numbers in order of installation.

INSTALLATION INSTRUCTIONS AND INFORMATION

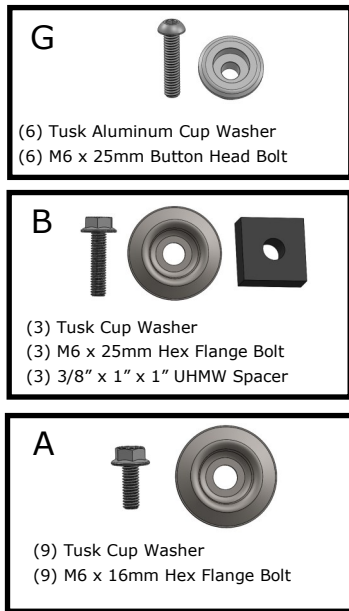

Tusk Middle Rear Skid Plate

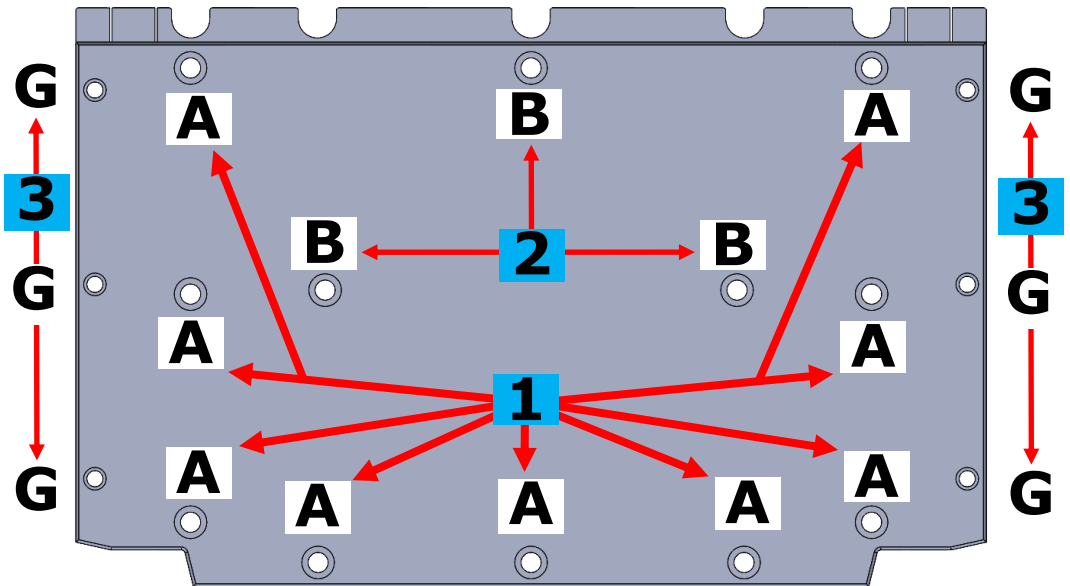

Tusk Quiet Glide Skid Plate Kawasaki KRX4 1000

Installation Middle Front Skid Plate Section:

- Remove the necessary existing OEM bolts and OEM washers from the front of the factory front skid plates. *It is optional to remove the OEM front skid plates.*
- Locate the supplied Tusk Middle Front Skid Plate and supplied corresponding hardware shown below. Begin installing the middle section of the skid plate using combination hardware (A) first. These bolts will thread into existing OEM frame welded nuts, loosely thread the bolts into outlined locations shown below. Locate and install combination hardware (B), place the provided UHMW spacers between the OEM welded frame nut and skid plate, thread the bolts and leave loose for now.
- Next, locate the supplied combination hardware (C). Place the provided UHMW spacers between the OEM welded frame nut and skid plate, thread the bolts and leave loose for now. Locate and install combination hardware (G). The bolts will thread into existing OEM threaded locations securing the sides of the skid plate, leave these loose for now. If bolts are difficult to install Bend Skid plate at the machined groove location. The skid plate is pre bent, but can relax after manufacturing. Adding bend can assist with the installation.
- When installing all hardware combinations, follow the outlined numbers in order of installation.

INSTALLATION INSTRUCTIONS AND INFORMATION

Tusk Middle Front Skid Plate

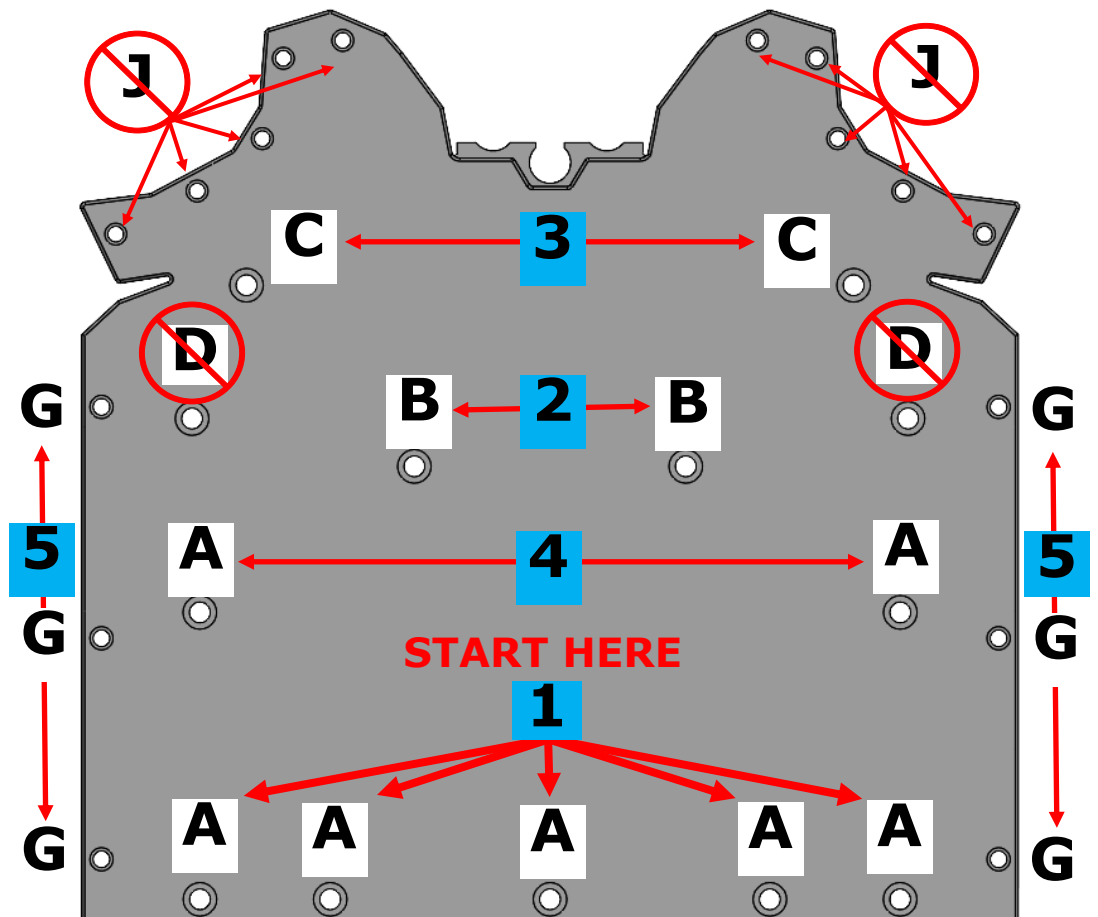

Tusk Quiet Glide Skid Plate Kawasaki KRX4 1000

Installation Front Skid Plate Section Instructions:

13. Locate the (F), (H) and (A) Hardware combinations and install the front skid plate. It is best if you install the (A) hardware first. Thread the skid plate bolts into the OEM welded nuts on the frame of the machine, leave these loose for now.
14. With hardware (A) loosely installed, adjust the skid plate for optimal fit. Next, locate the supplied 9/32" drill bit. On the machine (H) locations already have pilot holes from the factory. **CAUTION: Check for proper clearance when drilling to insure to not do any damage to the machine.** Use the supplied drill bit to carefully and slowly widen the OEM pilot holes in order to accept supplied (H) hardware. Install combination (H) hardware. Install the Tusk aluminum cup washers followed by the M6 bolts, secure the skid plate bolts using the M6 flanged nuts and leave these loose for now.
15. (F) locations already have pilot holes from the factory. **CAUTION: Check for proper clearance when drilling to insure to not do any damage to the machine.** Using the supplied 9/32" drill bit slowly and carefully begin drilling and widening the mounting holes. Install combination hardware (F), install (2) 5/16" self threading screws securing the skid plate to the machine.
16. At this point before you go any further with the install, go back and adjust the skid plate for optimal fit and tighten **ALL** loose hardware.

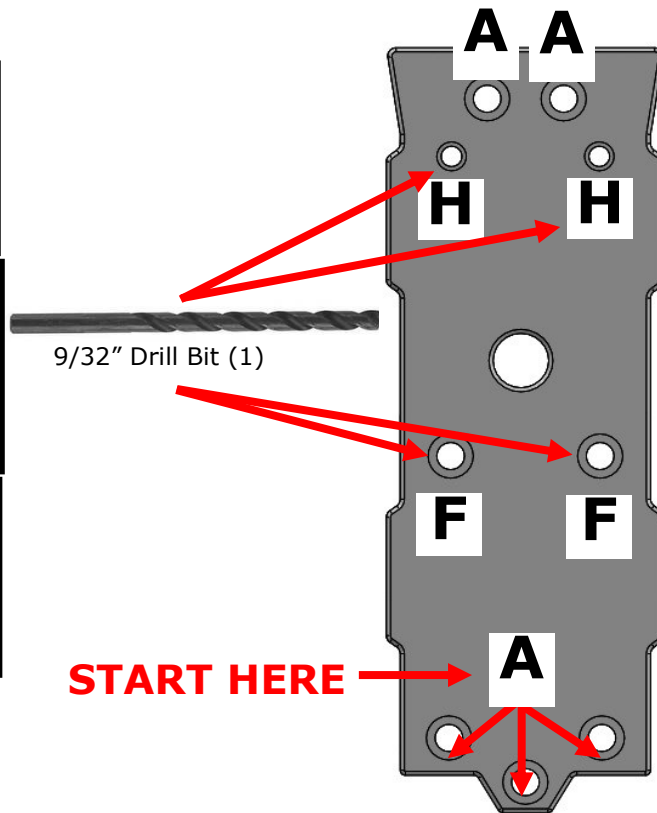

Tusk Quiet Glide Skid Plate Kawasaki KRX4 1000

Installation Combination Hardware (D) Middle Skid Plate Section:

17. Now that the skid plate has been adjusted for optimal fit, and all hardware is completely tight you can continue the install of the remaining hardware. This step will require some drilling. Check for proper clearance before drilling to insure not to do any damage to the machine. **CAUTION: This section of the skid plate is directly underneath the floor boards of the passenger side and driver side of the vehicle. Create clearance by removing the floor boards to insure you do not accidentally drill into the floor boards from under the machine during this step.** Locate the supplied 9/32" drill bit, using a center punch mark drill location. Carefully and slowly begin the drilling process on the underside of the machine found on section (D) of the skid plate shown below once you are through the material you will feel the drill bit release, do not drill any further. Do this for both (D) locations on the skid plate shown below.
18. Next, locate the supplied (D) combination hardware. Install the (2) 5/16" x 3/4" Self threading screws and cup washers into the previously drilled locations shown below.

INSTALLATION INSTRUCTIONS AND INFORMATION



9/32" Drill Bit (1)

Tusk Middle Skid Plate

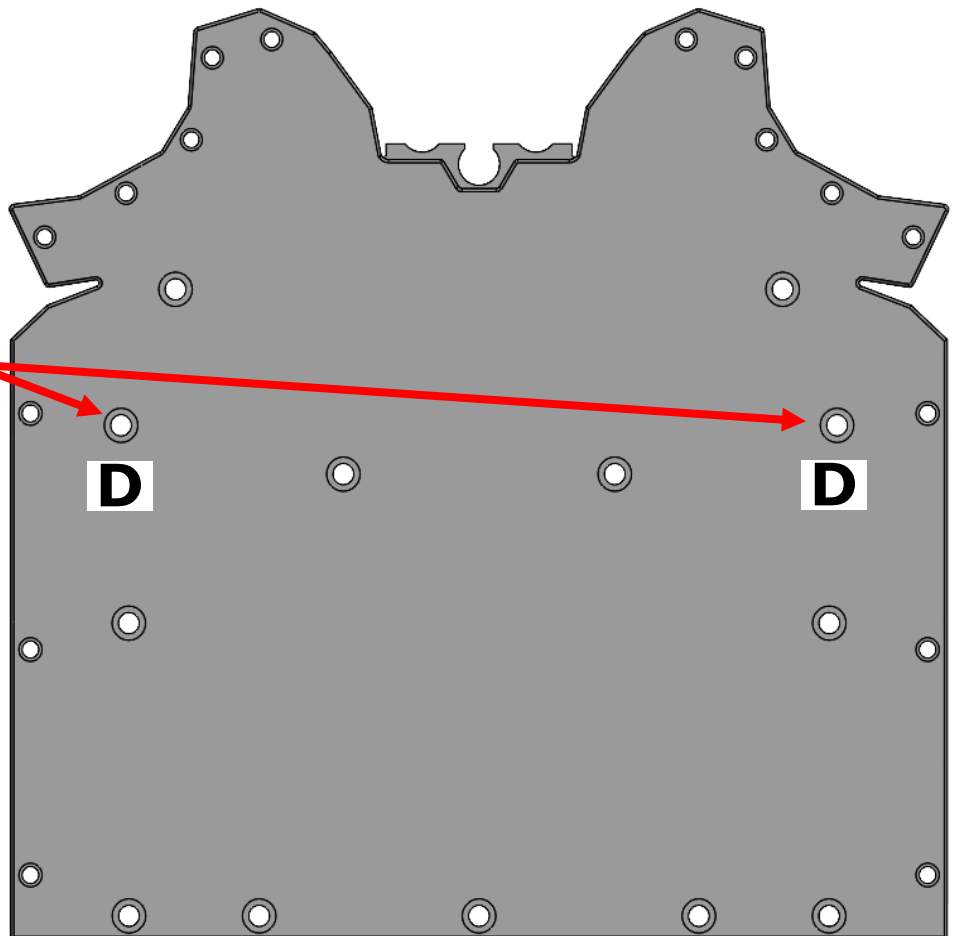

Tusk Quiet Glide Skid Plate Kawasaki KRX4 1000

Installing Middle Skid Plate Combination Hardware (J)

19. Locate the supplied combination hardware (J) and 7/32" drill bit for the installation of this skid plate section. Before you begin this step go back through and inspect your work. Make sure the skid plate is adjusted for optimal fit. Up to this point, all hardware has been installed and tight. *Note: For the completion of this step we recommend the help of a second person.* **CAUTION: This section of the skid plate is also directly underneath the floor boards of the passenger side and driver side of the vehicle. Create clearance by removing the floor boards to insure you do not accidentally drill into the floor boards from under the machine during this step.**
20. Order of drilling and installing is outlined below for combination hardware (J). This section of the skid plate will need to be flexed tightly around the underside of the machine. Begin by pressing the outlined section of the skid plate up against the machine. Using a punch tool, center your punch inside skid plate hole number 1 and punch your first drill mark. Next, carefully and slowly begin the drilling process using the 7/32" drill bit on the underside of the machine in hole number 1. Once you're through the material of the machine you will feel the drill bit release, *do not drill any further.* Install (1) Tusk aluminum cup washer on the skid plate followed by (1) 1/4" x 1/2" self tapping screw and fully drive it in tight. Continue the same outlined installation process steps of each combination (J) hardware. Continue following the order 1-5 until all hardware has been successfully installed in this section of the skid plate.
21. When all 1-5 have been drilled and hardware (J) combinations have been properly installed next, re-install the floor boards in the passenger side and driver side of the machine.
22. Double check that all hardware is tight, and enjoy the use of your new Tusk Quiet Glide Skid Plate!

